

# Withdrawal Sleeves

## Series AH2

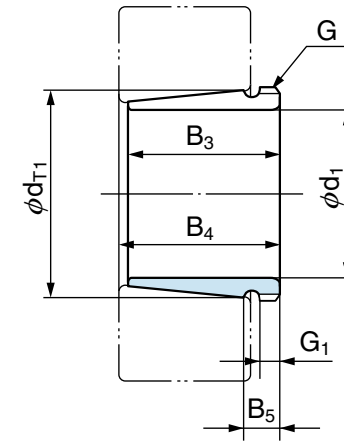

Bearing bore No.	Thread Nominal G		Dimensions (mm)					Mass (kg) (reference)	Withdrawal Sleeve No.	Locknut No.	
			$d_1$	$B_3$	$B_4$	$d_{T1}$	$B_5$				$G_1$ (reference)
08	M	45 × 1.5	35	25	27	41.50	9	6	0.094	AH 208	AN 09
09	M	50 × 1.5	40	26	29	46.67	9	6	0.104	AH 209	AN 10
10	M	55 × 2	45	28	31	51.15	10	7	0.130	AH 210	AN 11
11	M	60 × 2	50	29	32	56.83	10	7	0.167	AH 211	AN 12
12	M	65 × 2	55	32	35	62.00	11	8	0.175	AH 212	AN 13
13	M	75 × 2	60	32.5	36	67.08	11	8	0.242	AH 213	AN 15
14	M	80 × 2	65	33.5	37	72.17	11	8	0.255	AH 214	AN 16
15	M	85 × 2	70	34.5	38	77.25	11	8	0.280	AH 215	AN 17
16	M	90 × 2	75	35.5	39	82.33	11	8	0.306	AH 216	AN 18
17	M	95 × 2	80	38.5	42	87.50	12	9	0.353	AH 217	AN 19
18	M	100 × 2	85	40	44	92.67	12	9	0.427	AH 218	AN 20
19	M	105 × 2	90	43	47	97.83	13	10	0.486	AH 219	AN 21
20	M	110 × 2	95	45	49	103.00	13	10	0.525	AH 220	AN 22
21	M	115 × 2	100	47	51	108.08	14	11	0.580	AH 221	AN 23
22	M	120 × 2	105	50	54	113.33	14	11	0.647	AH 222	AN 24



# Withdrawal Sleeves

## Series AH2

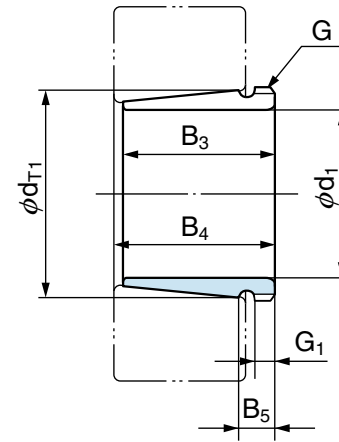

Bearing bore No.	Thread Nominal G	Dimensions (mm)						Mass (kg) (reference)	Withdrawal Sleeve No.	Locknut No.
		$d_1$	$B_3$	$B_4$	$d_{T1}$	$B_5$	$G_1$ (reference)			
24	M 130 × 2	115	53	57	123.50	15	12	0.755	AH 224	AN 26
26	M 140 × 2	125	53	57	133.50	15	12	0.815	AH 226	AN 28
28	M 150 × 2	135	56	61	143.75	16	13	1.00	AH 228	AN 30
30	M 160 × 3	145	60	65	154.00	17	14	1.16	AH 230	AN 32
32	M 170 × 3	150	64	69	164.25	18	15	1.91	AH 232	AN 34
34	M 180 × 3	160	69	74	174.58	19	16	2.21	AH 234	AN 36
36	M 190 × 3	170	69	74	184.58	19	16	2.34	AH 236	AN 38
38	Tr 205 × 4	180	73	78	194.58	23	17	2.94	AH 238	HNL41
40	Tr 215 × 4	190	77	82	204.83	24	18	3.12	AH 240	HNL43
44	Tr 235 × 4	200	85	91	225.58	24	18	6.10	AH 244	HNL47
48	Tr 260 × 4	220	96	102	246.17	28	22	8.16	AH 248	HNL52
52	Tr 280 × 4	240	105	111	266.83	29	23	9.89	AH 252	HNL56
56	Tr 300 × 4	260	105	113	287.00	29	23	10.4	AH 256	HNL60