

Adapter Assemblies

Series H2/HE2/HS2

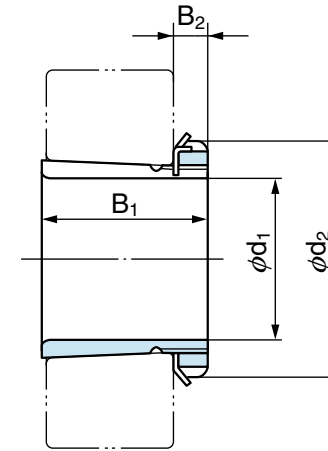

Bearing bore No.	Dimensions (mm)						Mass ⁽¹⁾ (kg) (reference)	Adapter Ass'y No.			Part No.		
	d ₁			d ₂	B ₁	B ₂		H	HE	HS	Adapter sleeve ⁽²⁾	Locknut	Lock-washer
	H	HE	HS										
04	17	–	–	32	24	7	0.041	H204X	–	–	A204X	AN 04	AW 04X
05	20	19.050	–	38	26	8	0.070	H205X	HE205X	–	A205X	AN 05	AW 05X
06	25	25.400	22.225	45	27	8	0.099	H206X	HE206X	HS206X	A206X	AN 06	AW 06X
07	30	–	28.575	52	29	9	0.125	H207X	–	HS207X	A207X	AN 07	AW 07X
08	35	31.750	34.925	58	31	10	0.174	H208X	HE208X	HS208X	A208X	AN 08	AW 08X
09	40	38.100	–	65	33	11	0.226	H209X	HE209X	–	A209X	AN 09	AW 09X
10	45	44.450	41.275	70	35	12	0.274	H210X	HE210X	HS210X	A210X	AN 10	AW 10X
11	50	50.800	47.625	75	37	12	0.308	H211X	HE211X	HS211X	A211X	AN 11	AW 11X
12	55	–	53.975	80	38	13	0.346	H212X	–	HS212X	A212X	AN 12	AW 12X

Notes (1) The masses in the table are for H series.

(2) The numbers in the table mean sleeves for H series. Sleeves for HE or HS series have prefix AE or AS.

Reference Suffix X means narrow axial slot type.

For this type sleeves, only lockwashers with straight inner tab can be used.



Adapter Assemblies

Series H2/HE2/HS2

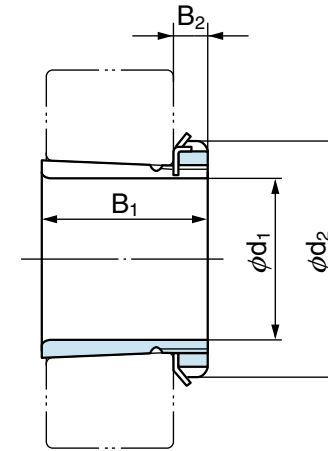

Bearing bore No.	Dimensions (mm)						Mass ⁽¹⁾ (kg) (reference)	Adapter Ass'y No.			Part No.		
	d ₁			d ₂	B ₁	B ₂		H	HE	HS	Adapter sleeve ⁽²⁾	Locknut	Lock-washer
	H	HE	HS										
13	60	57.150	60.325	85	40	14	0.401	H213X	HE213X	HS213X	A213X	AN 13	AW 13X
14	60	–	–	92	41	14	0.550	H214X	–	–	A214X	AN 14	AW 14X
15	65	63.500	66.675	98	43	15	0.708	H215X	HE215X	HS215X	A215X	AN 15	AW 15X
16	70	69.850	–	105	46	17	0.881	H216X	HE216X	–	A216X	AN 16	AW 16X
17	75	76.200	73.025	110	50	18	1.02	H217X	HE217X	HS217X	A217X	AN 17	AW 17X
18	80	–	79.375	120	52	18	1.18	H218X	–	HS218X	A218X	AN 18	AW 18X
19	85	82.550	85.725	125	55	19	1.37	H219X	HE219X	HS219X	A219X	AN 19	AW 19X
20	90	88.900	–	130	58	20	1.49	H220X	HE220X	–	A220X	AN 20	AW 20X
21	95	–	–	140	60	20	1.70	H221X	–	–	A221X	AN 21	AW 21X
22	100	101.600	–	145	63	21	1.93	H222X	HE222X	–	A222X	AN 22	AW 22X

Notes (1) The masses in the table are for H series.

(2) The numbers in the table mean sleeves for H series. Sleeves for HE or HS series have prefix AE or AS.

Reference Suffix X means narrow axial slot type.

For this type sleeves, only lockwashers with straight inner tab can be used.