

6. Internal Clearance of Rolling Contact Bearings

Bearing internal clearance refers to the distances between the bearing rings and rolling elements as shown in Fig. 6.1 and Fig. 6.2. The amount of alternating radial movement of the free bearing rings is defined as radial clearance, and the amount of alternating axial movement of the free bearing rings is defined as axial clearance.

The term internal clearance refers to a state where no force is applied to the bearing rings and rolling elements, i.e., an unloaded state.

Since a stabilizing, measuring load is applied to bearings when measuring the internal clearance, some elastic deformation occurs to the bearing rings and rolling elements, and the measured internal clearance will be larger than the real clearance by the value of deformation. The amount of elastic deformation caused by the measuring load may be disregarded for roller bearings, but must be compensated for when measuring ball bearing clearance because it will skew the internal clearance measurement.

Internal clearance values are described in the JIS (ISO) and the Japan Bearing Industrial Association Standards (BAS) as follows:

Deep-groove ball bearings }
Self-aligning ball bearings } JIS B1520
Cylindrical roller bearings } (ISO 5753)
Spherical roller bearings }

For electric motor

Deep-groove ball bearings }
Cylindrical roller bearings } BAS 1003

Bearings not covered by either JIS (ISO) or BAS are standardized by NACHI. [Tables 6.1 through 6.7](#) show internal clearance values for NACHI bearings.

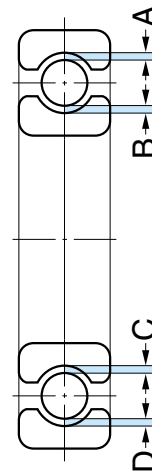

Fig. 6.1
Radial Clearance
= A+B+C+D

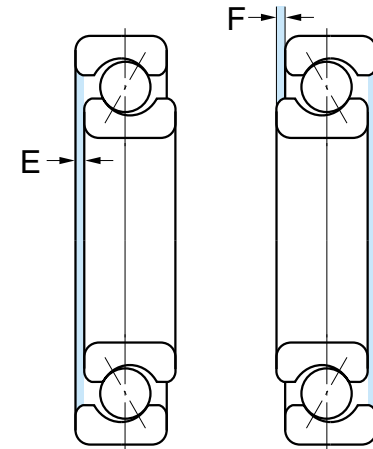

Fig. 6.2
Axial Clearance
= E+F





**Table 6.1 Radial Internal Clearance of Deep-groove Ball Bearings
(with Cylindrical Bore) (JIS)**

**Table 6.2 Radial Internal Clearance of Extra-small and Miniature Ball Bearings
(NACHI)**

Table 6.3 Radial Internal Clearance of Self-aligning Ball Bearings (JIS)

Radial Internal Clearance of Cylindrical Roller Bearings

- Table 6.4.1 Radial Internal Clearance of Cylindrical Roller Bearings with Cylindrical Bore (JIS)
- Table 6.4.2 Non-interchangeable Radial Internal Clearance of Cylindrical Roller Bearings with Tapered Bore (NACHI)

Radial Internal Clearance of Spherical Roller Bearings

- Table 6.5.1 Radial Internal Clearance of Spherical Roller Bearings with Cylindrical Bore (JIS)
- Table 6.5.2 Radial Internal Clearance of Spherical Roller Bearings with Tapered Bore (JIS)

**Table 6.6 Radial Internal Clearance of Double-row and Duplex Tapered Roller Bearings
with Cylindrical Bore (NACHI)**

Radial Internal Clearance of Bearings for Electric Motor

- Table 6.7.1 Radial Internal Clearance of Deep-groove Ball Bearings (BAS)
- Table 6.7.2 Radial Internal Clearance of Cylindrical Roller Bearings (BAS)

Table 6.1 Radial Internal Clearance of Deep-groove Ball Bearings (with Cylindrical Bore) (JIS) (1/2) Unit: μm

Bearing bore dia. Nominal d (mm)		Radial clearance									
		C2		CN (Normal)		C3		C4		C5	
Over	Incl.	min	max	min	max	min	max	min	max	min	max
2.5	6	0	7	2	13	8	23	–	–	–	–
6	10	0	7	2	13	8	23	14	29	20	37
10	18	0	9	3	18	11	25	18	33	25	45
18	24	0	10	5	20	13	28	20	36	28	48
24	30	1	11	5	20	13	28	23	41	30	53
30	40	1	11	6	20	15	33	28	46	40	64
40	50	1	11	6	23	18	36	30	51	45	73
50	65	1	15	8	28	23	43	38	61	55	90
65	80	1	15	10	30	25	51	46	71	65	105
80	100	1	18	12	36	30	58	53	84	75	120
100	120	2	20	15	41	36	66	61	97	90	140
120	140	2	23	18	48	41	81	71	114	105	160
140	160	2	23	18	53	46	91	81	130	120	180
160	180	2	25	20	61	53	102	91	147	135	200
180	200	2	30	25	71	63	117	107	163	150	230



**Table 6.1 Radial Internal Clearance of Deep-groove Ball Bearings (with Cylindrical Bore) (JIS) (2/2)** Unit: μm

Bearing bore dia. Nominal d (mm)		Radial clearance									
		C2		CN (Normal)		C3		C4		C5	
Over	Incl.	min	max	min	max	min	max	min	max	min	max
200	225	2	35	25	85	75	140	125	195	175	265
225	250	2	40	30	95	85	160	145	225	205	300
250	280	2	45	35	105	90	170	155	245	225	340
280	315	2	55	40	115	100	190	175	270	245	370
315	355	3	60	45	125	110	210	195	300	275	410
355	400	3	70	55	145	130	240	225	340	315	460
400	450	3	80	60	170	150	270	250	380	350	510
450	500	3	90	70	190	170	300	280	420	390	570
500	560	10	100	80	210	190	330	310	470	440	630
560	630	10	110	90	230	210	360	340	520	490	690
630	710	20	130	110	260	240	400	380	570	540	760
710	800	20	140	120	290	270	450	430	630	600	840
800	900	20	160	140	320	300	500	480	700	670	940
900	1000	20	170	150	350	330	550	530	770	740	1040
1000	1120	20	180	160	380	360	600	580	850	820	1150
1120	1250	20	190	170	410	390	650	630	920	890	1260

Table 6.2 Radial Internal Clearance of Extra-small and Miniature Ball Bearings (NACHI)

Unit: μm

Bearing bore dia. Nominal d (mm)		Radial clearance											
		C1P		C2P		C3P		C4P		C5P		C6P	
Over	Incl.	min	max	min	max	min	max	min	max	min	max	min	max
–	10	0	5	3	8	5	10	8	13	13	20	20	28

Remarks: The standard internal clearance is C3P.

Table 6.3 Radial Internal Clearance of Self-aligning Ball Bearings (JIS)

Unit: μm

Bearing bore dia. Nominal d (mm)		Radial clearance, cylindrical bore										Radial clearance, tapered bore									
		C2		CN (Normal)		C3		C4		C5		C2		CN (Normal)		C3		C4		C5	
Over	Incl.	min	max	min	max	min	max	min	max	min	max	min	max	min	max	min	max	min	max	min	max
2.5	6	1	8	5	15	10	20	15	25	21	33	–	–	–	–	–	–	–	–	–	–
6	10	2	9	6	17	12	25	19	33	27	42	–	–	–	–	–	–	–	–	–	–
10	14	2	10	6	19	13	26	21	35	30	48	–	–	–	–	–	–	–	–	–	–
14	18	3	12	8	21	15	28	23	37	32	50	–	–	–	–	–	–	–	–	–	–
18	24	4	14	10	23	17	30	25	39	34	52	7	17	13	26	20	33	28	42	37	55
24	30	5	16	11	24	19	35	29	46	40	58	9	20	15	28	23	39	33	50	44	62
30	40	6	18	13	29	23	40	34	53	46	66	12	24	19	35	29	46	40	59	52	72
40	50	6	19	14	31	25	44	37	57	50	71	14	27	22	39	33	52	45	65	58	79
50	65	7	21	16	36	30	50	45	69	62	88	18	32	27	47	41	61	56	80	73	99
65	80	8	24	18	40	35	60	54	83	76	108	23	39	35	57	50	75	69	98	91	123
80	100	9	27	22	48	42	70	64	96	89	124	29	47	42	68	62	90	84	116	109	144
100	120	10	31	25	56	50	83	75	114	105	145	35	56	50	81	75	108	100	139	130	170
120	140	10	38	30	68	60	100	90	135	125	175	40	68	60	98	90	130	120	165	155	205
140	160	15	44	35	80	70	120	110	161	150	210	45	74	65	110	100	150	140	191	180	240

Radial Internal Clearance of Cylindrical Roller Bearings

Table 6.4.1 Radial Internal Clearance of Cylindrical Roller Bearings with Cylindrical Bore (JIS)

Unit: μm

Bearing bore diameter Nominal d (mm)		Radial clearance									
		C2		CN (Normal)		C3		C4		C5	
Over	Incl.	min	max	min	max	min	max	min	max	min	max
–	10	0	25	20	45	35	60	50	75	–	–
10	24	0	25	20	45	35	60	50	75	65	90
24	30	0	25	20	45	35	60	50	75	70	95
30	40	5	30	25	50	45	70	60	85	80	105
40	50	5	35	30	60	50	80	70	100	95	125
50	65	10	40	40	70	60	90	80	110	110	140
65	80	10	45	40	75	65	100	90	125	130	165
80	100	15	50	50	85	75	110	105	140	155	190
100	120	15	55	50	90	85	125	125	165	180	220
120	140	15	60	60	105	100	145	145	190	200	245
140	160	20	70	70	120	115	165	165	215	225	275
160	180	25	75	75	125	120	170	170	220	250	300
180	200	35	90	90	145	140	195	195	250	275	330
200	225	45	105	105	165	160	220	220	280	305	365
225	250	45	110	110	175	170	235	235	300	330	395
250	280	55	125	125	195	190	260	260	330	370	440
280	315	55	130	130	205	200	275	275	350	410	485
315	355	65	145	145	225	225	305	305	385	455	535
355	400	100	190	190	280	280	370	370	460	510	600
400	450	110	210	210	310	310	410	410	510	565	665
450	500	110	220	220	330	330	440	440	550	625	735

Table 6.4.2 Non-interchangeable Radial Internal Clearance of Cylindrical Roller Bearings with Tapered Bore (NACHI) Unit: μm

Bearing bore diameter Nominal d (mm)		Radial clearance					
		C9na		C1na		C2na	
Over	Incl.	min	max	min	max	min	max
14	18	5	10	10	20	20	30
18	24	5	10	10	20	20	30
24	30	5	10	15	25	25	35
30	40	5	12	15	25	25	40
40	50	5	15	17	30	30	45
50	65	5	15	20	35	35	50
65	80	10	20	25	40	40	60
80	100	10	25	35	55	45	70
100	120	10	25	40	60	50	80
120	140	15	30	45	70	60	90
140	160	15	35	50	75	65	100
160	180	15	35	55	85	75	110
180	200	20	40	60	90	80	120
200	225	20	45	60	95	90	135
225	250	25	50	65	100	100	150
250	280	25	55	75	110	110	165
280	315	30	60	80	120	120	180
315	355	30	65	90	135	135	200
355	400	35	75	100	150	150	225
400	450	40	85	110	170	170	255
450	500	45	95	120	190	190	285

Remarks: JIS (ISO) has not standardized non-interchangeable radial clearance for tapered bore bearings.

Radial Internal Clearance of Spherical Roller Bearings

Table 6.5.1 Radial Internal Clearance of Spherical Roller Bearings with Cylindrical Bore (JIS)

Unit: μm

Bearing bore diameter Nominal d (mm)		Radial clearance									
		C2		CN (Normal)		C3		C4		C5	
Over	Incl.	min	max	min	max	min	max	min	max	min	max
14	18	10	20	20	35	35	45	45	60	60	75
18	24	10	20	20	35	35	45	45	60	60	75
24	30	15	25	25	40	40	55	55	75	75	95
30	40	15	30	30	45	45	60	60	80	80	100
40	50	20	35	35	55	55	75	75	100	100	125
50	65	20	40	40	65	65	90	90	120	120	150
65	80	30	50	50	80	80	110	110	145	145	180
80	100	35	60	60	100	100	135	135	180	180	225
100	120	40	75	75	120	120	160	160	210	210	260
120	140	50	95	95	145	145	190	190	240	240	300
140	160	60	110	110	170	170	220	220	280	280	350
160	180	65	120	120	180	180	240	240	310	310	390
180	200	70	130	130	200	200	260	260	340	340	430
200	225	80	140	140	220	220	290	290	380	380	470
225	250	90	150	150	240	240	320	320	420	420	520
250	280	100	170	170	260	260	350	350	460	460	570
280	315	110	190	190	280	280	370	370	500	500	630
315	355	120	200	200	310	310	410	410	550	550	690
355	400	130	220	220	340	340	450	450	600	600	750
400	450	140	240	240	370	370	500	500	660	660	820
450	500	140	260	260	410	410	550	550	720	720	900
500	560	150	280	280	440	440	600	600	780	780	1000
560	630	170	310	310	480	480	650	650	850	850	1100
630	710	190	350	350	530	530	700	700	920	920	1190
710	800	210	390	390	580	580	770	770	1010	1010	1300
800	900	230	430	430	650	650	860	860	1120	1120	1440
900	1000	260	480	480	710	710	930	930	1220	1220	1570

Table 6.5.2 Radial Internal Clearance of Spherical Roller Bearings with Tapered Bore (JIS)

Unit: μm

Bearing bore diameter Nominal d (mm)		Radial clearance									
		C2		CN (Normal)		C3		C4		C5	
Over	Incl.	min	max	min	max	min	max	min	max	min	max
18	24	15	25	25	35	35	45	45	60	60	75
24	30	20	30	30	40	40	55	55	75	75	95
30	40	25	35	35	50	50	65	65	85	85	105
40	50	30	45	45	60	60	80	80	100	100	130
50	65	40	55	55	75	75	95	95	120	120	160
65	80	50	70	70	95	95	120	120	150	150	200
80	100	55	80	80	110	110	140	140	180	180	230
100	120	65	100	100	135	135	170	170	220	220	280
120	140	80	120	120	160	160	200	200	260	260	330
140	160	90	130	130	180	180	230	230	300	300	380
160	180	100	140	140	200	200	260	260	340	340	430
180	200	110	160	160	220	220	290	290	370	370	470
200	225	120	180	180	250	250	320	320	410	410	520
225	250	140	200	200	270	270	350	350	450	450	570
250	280	150	220	220	300	300	390	390	490	490	620
280	315	170	240	240	330	330	430	430	540	540	680
315	355	190	270	270	360	360	470	470	590	590	740
355	400	210	300	300	400	400	520	520	650	650	820
400	450	230	330	330	440	440	570	570	720	720	910
450	500	260	370	370	490	490	630	630	790	790	1000
500	560	290	410	410	540	540	680	680	870	870	1100
560	630	320	460	460	600	600	760	760	980	980	1230
630	710	350	510	510	670	670	850	850	1090	1090	1360
710	800	390	570	570	750	750	960	960	1220	1220	1500
800	900	440	640	640	840	840	1070	1070	1370	1370	1690
900	1000	490	710	710	930	930	1190	1190	1520	1520	1860

Table 6.6 Radial Internal Clearance of Double-row and Duplex Tapered Roller Bearings with Cylindrical Bore (NACHI)

Unit: μm

Bearing bore diameter Nominal d (mm)		Radial clearance											
		C1		C2		CN (Normal)		C3		C4		C5	
Over	Incl.	min	max	min	max	min	max	min	max	min	max	min	max
14	18	2	10	10	20	20	30	35	45	45	55	65	75
18	24	2	10	10	20	20	30	35	45	45	55	65	75
24	30	2	10	10	25	25	35	40	50	50	60	70	80
30	40	2	12	12	25	25	40	45	55	55	70	80	95
40	50	2	15	15	30	30	45	50	65	65	80	95	110
50	65	2	15	15	35	35	50	55	75	75	90	110	130
65	80	5	20	20	40	40	60	70	90	90	110	130	150
80	100	5	25	25	45	45	70	80	105	105	125	155	180
100	120	5	25	25	50	50	80	95	120	120	145	180	205
120	140	10	30	30	60	60	90	105	135	135	160	200	230
140	160	10	35	35	65	65	100	115	150	150	180	225	260
160	180	10	35	35	75	75	110	125	165	165	200	250	285
180	200	10	40	40	80	80	120	140	180	180	220	275	315
200	225	10	45	45	90	90	135	155	200	200	240	305	350
225	250	15	50	50	100	100	150	170	215	215	265	330	380
250	280	15	55	55	110	110	165	185	240	240	295	370	420
280	315	15	60	60	120	120	180	205	265	265	325	410	470
315	355	15	65	65	135	135	200	225	295	295	360	455	520
355	400	20	75	75	150	150	225	255	330	330	405	510	585
400	450	20	85	85	170	170	255	285	370	370	455	565	650
450	500	20	95	95	190	190	285	315	410	410	505	625	720

Radial Internal Clearance of Bearings for Electric Motor

Table 6.7.1 Radial Internal Clearance of Deep-groove Ball Bearings (BAS) Unit: μm

Bearing bore diameter Nominal d (mm)		Radial clearance CM	
Over	Incl.	min	max
10 ⁽¹⁾	18	4	11
18	30	5	12
30	50	9	17
50	80	12	22
80	120	18	30
120	160	24	38

Note: (1) 10 mm is included in this group.

Remarks: The value in this table is under the condition of unloaded state.

Table 6.7.2 Radial Internal Clearance of Cylindrical Roller Bearings (BAS) Unit: μm

Bearing bore diameter Nominal d (mm)		Radial clearance			
		Interchangeable CT		Non-interchangeable CT	
Over	Incl.	min	max	min	max
24	40	15	35	15	30
40	50	20	40	20	35
50	65	25	45	25	40
65	80	30	50	30	45
80	100	35	60	35	55
100	120	35	65	35	60
120	140	40	70	40	65
140	160	50	85	50	80
160	180	60	95	60	90
180	200	65	105	65	100

Remarks: "Interchangeability" in this table means interchangeability between NACHI bearings only not with other brand bearings.